

M/V BLUE SPIRIT GALAPAGOS



VESSEL INFORMATION

Ship Capacity:	16 passengers
Group Sizes:	16 pax
Year Ship was Built:	2001
Last Refurbished:	Spring 2019
Star Rating:	Tourist Superior
Doctor/First Aid Onboard:	No/Yes
# of Decks:	4
# of Cabins:	10 cabins
Indoor/Outdoor Cabins:	6 Indoor cabins (Portholes) / 4 Outdoor Cabins (Windows)
Length:	104 feet
Beam:	22 feet
Draft:	5 feet
Registry:	Puerto Ayora- Islas Galapagos TN-01-0108
Gross Tonnage:	200,25
Power:	442 HP each motor (2 motors)
Generators:	Electric Generators
Cruising Speed:	12 Knots
Navigation Speed:	10 Knots
Engine Location:	Lower deck
Officers:	9 members: including Naturalist guide
Electric Current:	Yes – 110V
Smoking Regulations:	Smoking is only available in a specific area on the sun deck

Public Areas Onboard:	Bar, Dining room, Lounge, Sun deck, diving platform
Elevator:	No
Sun Deck:	Yes
Additional Information:	The boat is still operating in Galapagos as Tip Top III – The Blue Spirit operation is confirmed for September 2019.

CABIN INFORMATION

Cabins with Portholes:	6
Cabins with Windows:	4
Cabins with Balconies:	No
Windows:	Yes
Sitting Area in Cabin:	No
Telephone:	No, only in the reception
Safe in Cabin:	Yes
TV:	No, only in the lounge
Mini Fridge:	No, only in the bar
Air Conditioning/Heat:	Yes
Bed Types:	Twins and matrimonial
Closet:	Yes
Private Bathroom:	Yes
Private Shower in Cabin:	Yes
Bathroom Amenities:	Yes
# of Plugs in Cabin:	4
# of Plugs near Bed:	2
Hair Dryer in Cabin:	No
Iron in Cabin:	No
Adapter/Converter Needed:	European (yes)
Plug Type Needed Onboard:	American
Website & Unbranded Page:	coming soon
Triple Cabins:	No
Single Supplement:	50%
Blue Spirit issues tickets:	Yes (if not, an administrative charge of USD 60% + taxes will apply in order to fulfill airline conditions)
Fuel Surcharge	Included (it could vary in case of changes on the political or the Galapagos situation)
Snorkeling equipment:	Provided on board
Wet Suites:	For Rental
Children on the Naturalist Cruise	Up 7 years (1 kid per 2 adults confirmed will receive a 20% discount)



Children on the Diving Cruise	Up 16 years with license and certification
Operation:	Each Wednesday. All our naturalist departures can be confirmed as diving weeks. The diving week, will not be converted into naturalist departures.
Wheelchair Accessible:	This ship is NOT wheelchair accessible.
Accepts disabled people:	Yes – You must send all the details

COMMUNICATING WITH THE SHIP

Internet Access Onboard / Emails:	Only near to the harbors
Computer Available:	Yes
Reception Telephone #:	TBA

DINING/SPECIAL MEALS/DRESS ONBOARD

# of Dining Rooms Onboard:	One
Bar/Lounge Onboard:	One bar and one lounge
Special Meals:	Yes (according with previous passenger specifications – Salt/Vegan/Gluten Free/Vegetarian/Allergies, etc)
Dress Onboard:	Casual
Complimentary Beverages:	One drink on breakfast, Lunch and Dinner. Water, coffee and tea are available
Wine Bottles for Purchase:	Yes
Corkage Fee:	USD 15.- per each bottle

PAYMENTS ONBOARD

Mastercard:	Yes
Visa:	Yes
Tipping Onboard:	Tips are not compulsory. They will be considered under guest discretion. If you would like to reward our guides and crew for their excellence, you can consider a 10% of the cruise rate. (They will really appreciate your kindness)

ADDITIONAL INFORMATION

Laundry Service Available:	No
Life Jackets Available:	Yes
Additional Safety Gear Available:	All equipment's requested by National Park
Distilled Water Available Onboard:	Yes
Reception Area:	Yes
Room Service:	No
Café:	Yes
Gift Shop Onboard:	Yes
Library Onboard:	Yes

DESCRIPTION OF THE CABINS

BLUE SPIRIT GALAPAGOS	BED SIZES		CABIN AREA
	LENGHT	WIDTH	
CABINS 1-2 / 1 DBL - 1 TWIN BED	2.00	1.22	10.80
CABINS 3-6 / 2 TWIN BEDS	2.00	1.00	10.80
CABINS 7-8 / 1 DBL BED	2.00	1.22	8.125
CABINS 9-10 / 2 TWIN BEDS	2.00	0.90	9.50

DECK PLAN

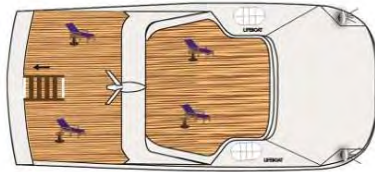

SUN DECK

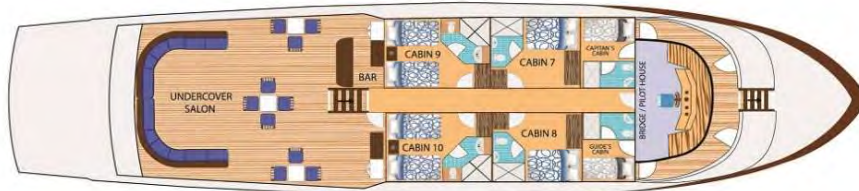

UPPER DECK

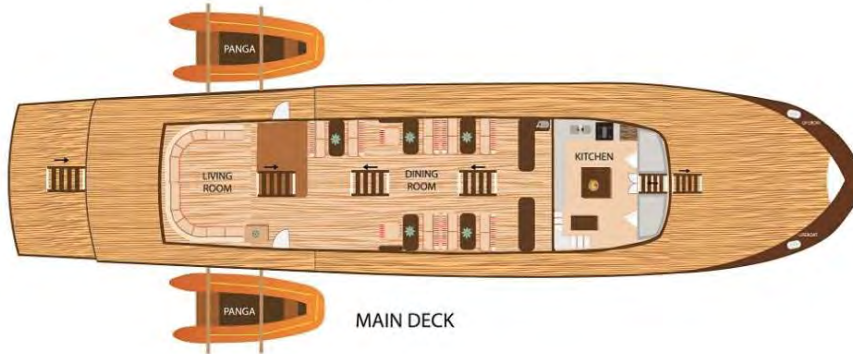

MAIN DECK

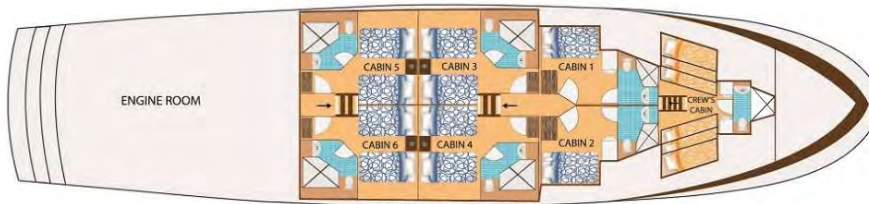

LOWER DECK

DIVING GEAR RENTAL	
GEAR	7 NIGHTS CRUISE
BCD	\$80,00
BOOTS & HOODS	\$30,00
DIVE COMPUTER	\$70,00
FINS	\$30,00
SNORKELING EQUIP.	\$20,00
REGULATOR	\$80,00
WETSUIT	\$70,00
15 L TANK	\$60,00
FULL SET EQUIPMENT	\$235,00
NITROX	\$150,00
Notes:	
Net price per person	
<p>The person who rents the equipment is responsible for any loss or damage to the rented equipment while in his/her possession and agrees to return it in the same condition as received. All rental gear must be rinsed with fresh water and properly cleaned before it is returned. In case of damages, the renter will have to cover its expenses</p>	
<p>We will need the following information: Size XS, S, M, L, XL, XXL; Gender: Male or Female</p>	
<p>Each passenger must bring Gloves and torch.</p>	